



OUTBACK MOTORCYCLE

Aprilia Tuareg 660

QUICK ASSEMBLY GUIDE | CRASH BARS

Number	QTY	Specifications	Torque (NM)
<u>1</u>	2	M10 x 65mm Allen Bolt	*
<u>2</u>	1	M10 x 40mm Allen Bolt	*
<u>3</u>	1	M10 x 35mm Allen Bolt	*
<u>4</u>	4	M10 Washer	-
<u>5</u>	4	M6 x 20mm Allen	10
<u>6</u>	10	M6 Washer	-
<u>7</u>	2	M6 Nyloc Nut	-
<u>8</u>	2	18mm Spacer	-
<u>9</u>	1	10mm Spacer	-

* PLEASE REFER TO THE OWNER'S (OR SERVICE) MANUAL FOR OEM TORQUE SPECIFICATIONS.*

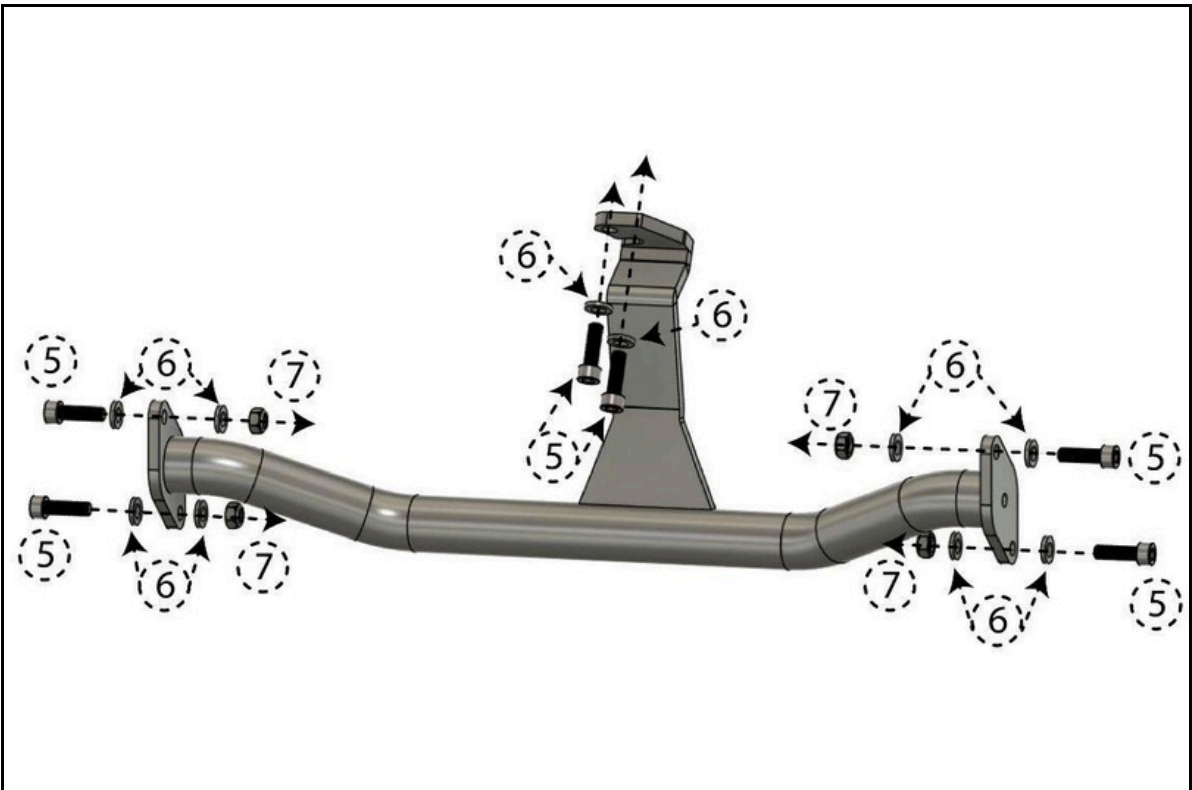



* PLEASE REFER TO THE OWNER'S (OR SERVICE) MANUAL FOR OEM TORQUE SPECIFICATIONS.*